



www.cyanlux.com

# LED Linear Trunking System

- 160LM/W
- ENEC approved
- 5 Years Warranty
- Compatible with 95% existing T5/T8 trunking



## LED Linear Trunking System

220-240V

Retrofit and Compatible with Following Trunking



## 1 • Features

### 1 - Fast installation 43 seconds



### 2 - Owned Lens Design



- Even distribution
- No gap
- PMMA no yellowing
- Easy for clean

### 3 - Power Turnable

- Tridonic: 60W/55W/50W/45W/42W
- Osram: 60W/50W/42W/32W
- AGT: 60W/64W/68W/72W

### 4 - Easily linkable



## 2 • Explosion Drawing

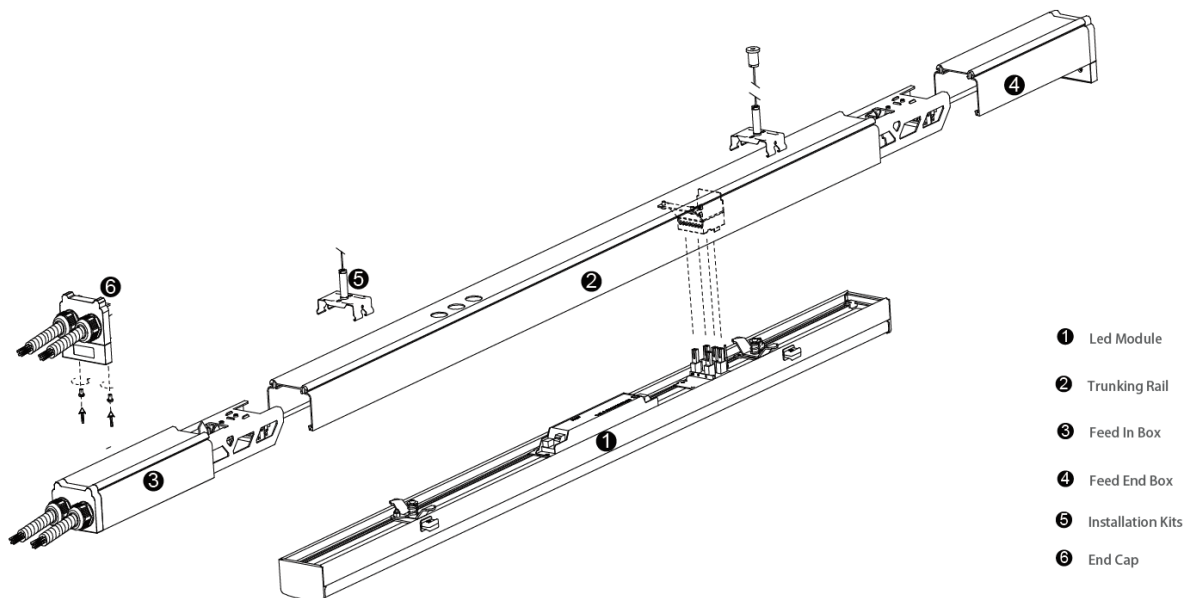

## 3 • Application

Supermarkets, warehouses, production lines, exhibition & showrooms, offices and meeting rooms



## 4•Trunking

### - Dimension (mm)

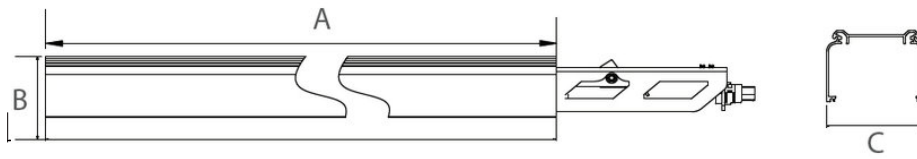

Model NO.	Size A(mm)	Size B(mm)	Size C(mm)
TKA2	578	72/82	65
TKA4	1150	72/82	65
TKA5	1438	72/82	65
TKA9	2876	72/82	65

### - Wiring system

2 cables for dimming  
(2 x 2.5 mm<sup>2</sup>)

4 cables for emergency lighting circuits  
(4 x 2.5 mm<sup>2</sup>)

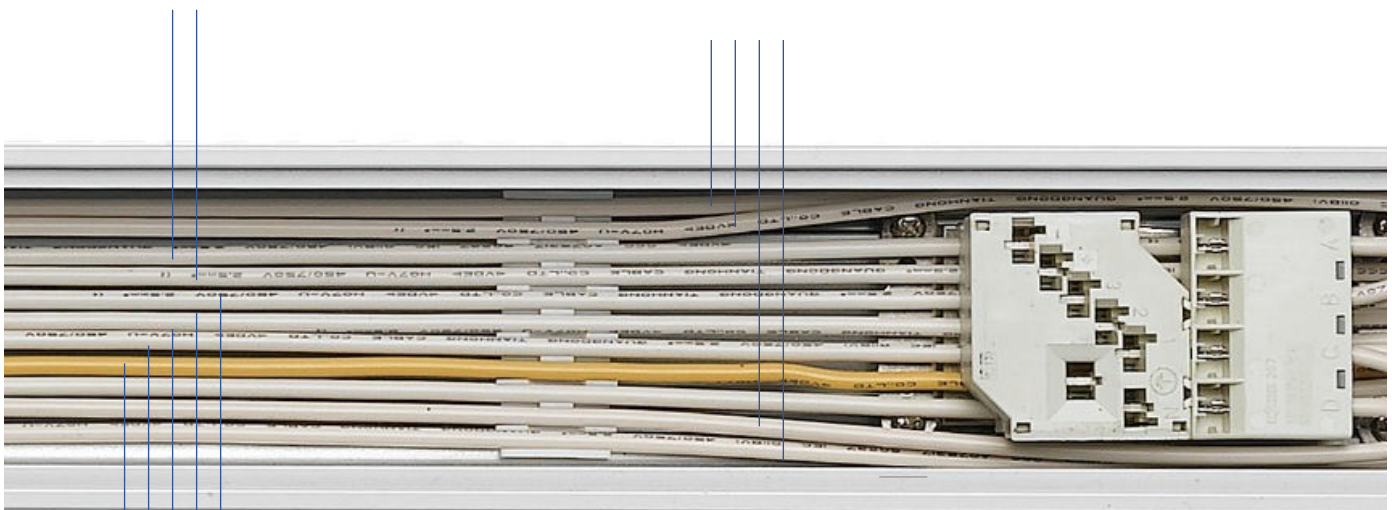

5 cables for power supply (5 x 2.5 mm<sup>2</sup>)  
· L1, L2, L3, N, FG

■ 5 Wires: L1, L2, L3, N, FG

■ 7 Wires: L1, L2, L3, N, FG & DIM+, DIM-

■ 11 Wires: L1, L2, L3, N, FG & DIM+, DIM-

& 4 wires for Emergency converter & Battery

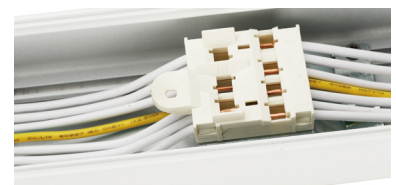

## • Trunking Specification

\*New trunking is not mandatory, our system is compatible with 95% of existing T5/T8 trunking, save your cost again!

Length	Model No.	Wires	Function	Description	Picture
600mm (578mm)	TKA2-05W	5 wires	Non-Dimming	5 x 2.5 mm <sup>2</sup> cable pre-wired	
	TKA2-07W	7 wires	1-10V /Dali	7 x 2.5 mm <sup>2</sup> cable pre-wired	
	TKA2-11W	11 wires	Emergency	11 x 2.5 mm <sup>2</sup> cable pre-wired	
1500mm (1438mm)	TKA5-05W	5 wires	Non-Dimming	5 x 2.5 mm <sup>2</sup> cable pre-wired	
	TKA5-07W	7 wires	1-10V /Dali	7 x 2.5 mm <sup>2</sup> cable pre-wired	
	TKA5-11W	11 wires	Emergency	11 x 2.5 mm <sup>2</sup> cable pre-wired	
3000mm (2876mm)	TKA9-05W	5 wires	Non-Dimming	5 x 2.5 mm <sup>2</sup> cable pre-wired	
	TKA9-07W	7 wires	1-10V /Dali	7 x 2.5 mm <sup>2</sup> cable pre-wired	
	TKA9-11W	11 wires	Emergency	11 x 2.5 mm <sup>2</sup> cable pre-wired	

## 5• LED Light Module



- PMMA Optical Lens (H: 27mm)



- PC Diffuser (H:37 mm)

## • Wire connector plug

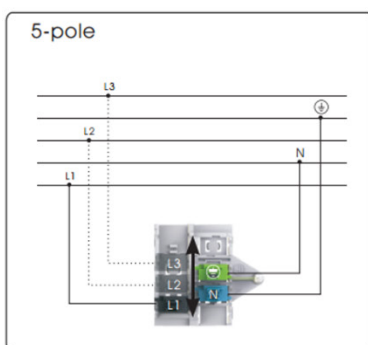

3 Pin wire connector plug:

For 5 wiring trunking rail

\* Green: FG

\* Blue: N

\* Black: L1, L2, L3 phase selection knob

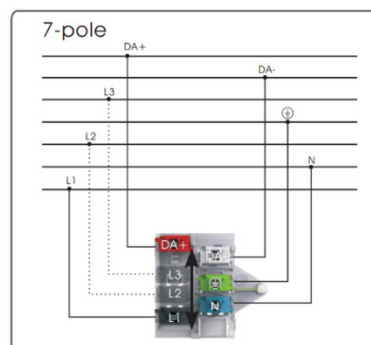

5 Pin wire connector plug:

For 7 wiring trunking rail

\* Green: FG

\* Blue: N

\* Red/White: D+/D-, DIM+/DIM-

\* Black: L1, L2, L3 phase selection knob

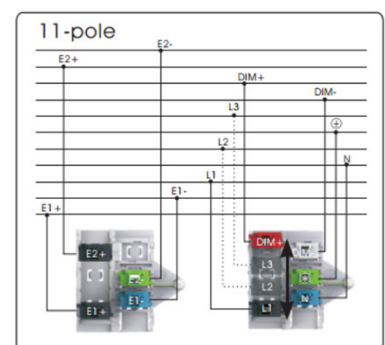

9Pin wire connector plug:

For 11 wiring trunking rail

\* D+/D-: Dimming driver

\* A/B/C/D: Emergency driver and battery

\* L: L1, L2, L3 phase selection knob

## • LED Module Specification

### - with Osram Driver | Non-Dimming

Length	Product Code	Power	Lumen	LM/W	Input Voltage	PF/THD	CCT	IP	Function
1438mm	RSL-60-S1	60W can adjust 50W/42W/32W	MAX9600LM	160 Lm/W	AC220-240V	PF>0.95/THD<15%	3000-6500K	IP40	NO-Dimming

### - with Tridonic Driver | Non-Dimming & DALI

Length	Product Code	Power	Lumen	LM/W	Input Voltage	PF/THD	CCT	IP	Function
1438mm	RSL-60-T1	60W can adjust 55W/50W/42W	MAX9600LM	160 Lm/W	AC/DC220-240V	PF>0.95/THD<15%	3000-6500K	IP40	NO-Dimming
1438mm	RSL-70-T4	16-70W	Max 10000LM	150 Lm/W	AC/DC220-240V	PF>0.95/THD<15%	3000-6500K	IP40	DALI

### - with ENEC approved AGT Driver | 1-10V Dimming

Length	Product Code	Power	Lumen	LM/W	Input Voltage	PF/THD	CCT	IP	Function
1438mm	RSL-72-A3	72W can adjust 68W/64W/60W	Max 10000LM	150 Lm/W	AC/DC 220-240V	PF>0.95/THD<15%	3000-6500K	IP40	1-10V

## • Beam Angle

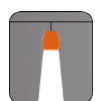

30°



60°



90°

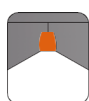

120°

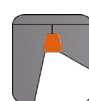

Asymmetric-R



Asymmetric-L



25° Double

## • Other Specs

. Aluminum +PC/PMMA

. White Frame

. Operation Temperature:  
-15°C~+50°C

. Microwave Sensor

. L70B50 @Ta 25°C: 80000h

. 5 years warranty

. Storage: -25°C~+55°C

.SMD2835 RA>80

## • Maximum loading of automatic circuit breakers

Automatic circuit breaker type	C10	C13	C16	C20	B10	B13	B16	B20	Inrush current	
Installation	1.5 mm <sup>2</sup>	1.5 mm <sup>2</sup>	1.5 mm <sup>2</sup>	2.5 mm <sup>2</sup>	1.5 mm <sup>2</sup>	1.5 mm <sup>2</sup>	1.5 mm <sup>2</sup>	2.5 mm <sup>2</sup>	I <sub>max</sub>	Time
Tridonic 72W	21	28	36	46	13	17	22	28	33 A	250 μs
OSRAM 65W					8		13		40 A	200 μs
OSRAM 60W					8		13		53 A	300 μs

## 6• Accessory part

### • Track Rail Module

\* can be mounted with track spotlight, track downlight, motion sensor, emergency exit sign etc.,

Length	Model No.	Track Rail Length	Picture
578mm	TR-06-05	578mm 5 wires	
	TR-06-07	578mm 7 wires	
1438mm	TR-15-05	1438mm 5 wires	
	TR-15-07	1438mm 7 wires	

### • Blank Cover

Length	Model No.	Description	Picture
578mm	RE-06-FF	578mm / PC material	
	RE-06-AL	578mm / Aluminum	
1438mm	RE-15-FF	1438mm / PC material	
	RE-15-AL	1438mm / Aluminum	

### • Node connection



Feed End Box



Feed In Box



End Cap



L Node connectors



T Node connectors



X Node connectors

### • Installation Kits



Surface mounted kit



Chain suspension kits



Steel cable suspension kits



Feed in connector



Cable gland

## 7• Installation

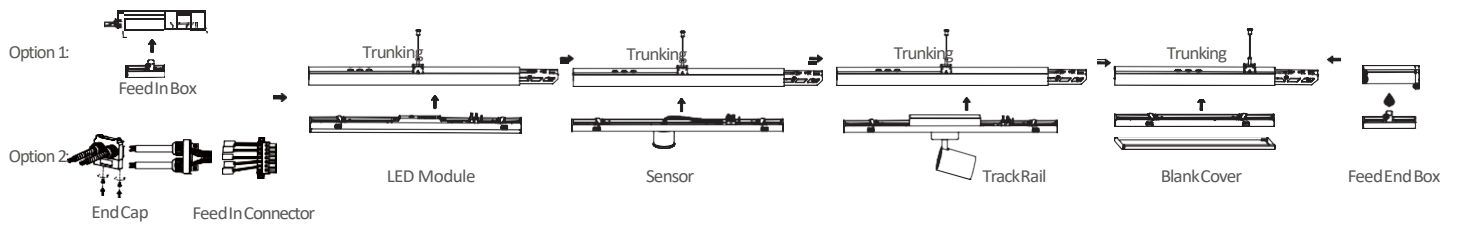

### Installation Drawing

#### Step 1

##### Installation suspension

###### Chain suspension

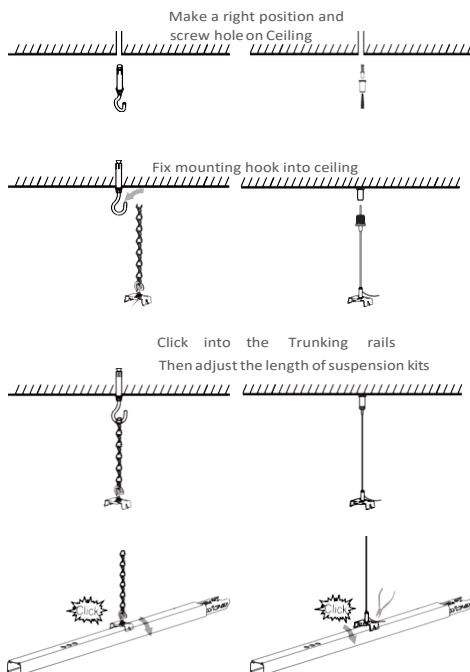

###### Steel cable Suspension

#### Step 2

##### Connecting Trunking

Both trunking rails keep in one line, then push

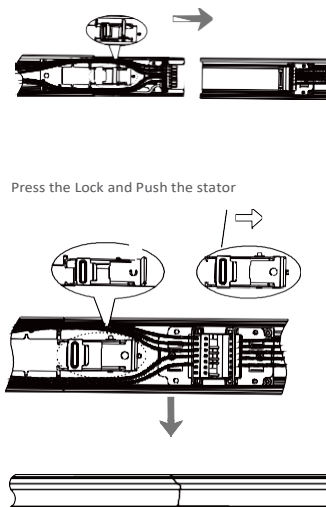

#### Step 3

##### Mounting LED Module

Slide knob to select phase L1/L2/L3

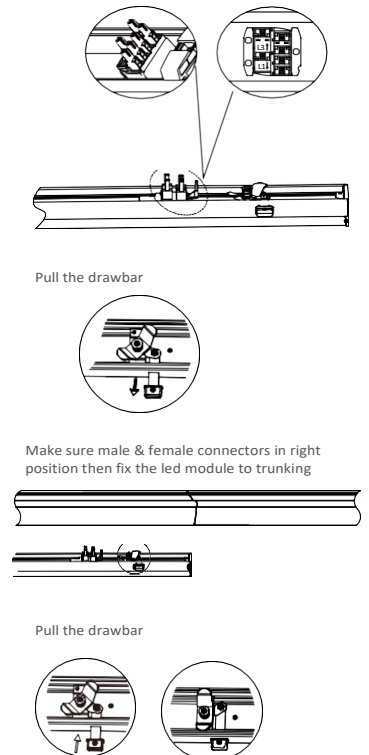

#### Step 4

##### Mounting Accessory part

###### Mounting Sensor

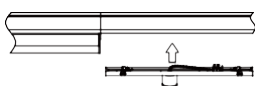

###### Mounting Track Rail



###### Mounting Blind cover

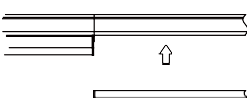

#### Step 5

##### Connecting Power Supply

Option 1: Use the Feed In BOX

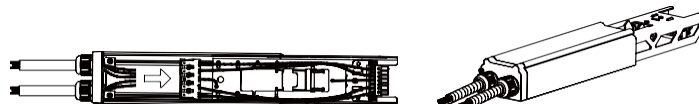

Option 2: Use the End Cap and Feed In Connector

Screw

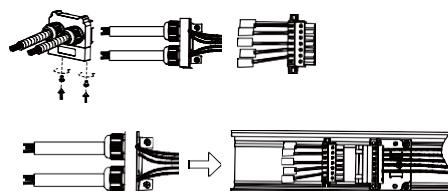



## ■ How many LED fixtures we could connect on one line

Input Voltage	MaxQty	Input Voltage	MaxQty
230VAC/32W	92	230VAC/56W	52
230VAC/35W	84	230VAC/60W	49
230VAC/38W	77	230VAC/64W	46
230VAC/42W	70	230VAC/68W	43
230VAC/50W	58	230VAC/72W	40

## • Maintenance

- To avoid injuries, disconnect power to the trunking rail and allow the unit to cool down before performing maintenance.
- Perform visual, mechanical and electrical inspections on a regular basis. We recommend routine checks to be made on an annual basis. Frequency of use and environment should determine this.
- The lens or covers should be cleaned periodically as needed to ensure continued photometric performance. Clean the lens with a damp, non-abrasive, lint-free cloth. If not sufficient, use mild soap or a liquid cleaner. Do not use an abrasive, strong alkaline or acid cleaner as damage may occur.
- Inspect the topside on the luminaire to ensure that it is free of any obstructions or contamination (i.e. excessive dust build-up). Clean with a non-abrasive cloth if needed.



## • Safety notes and Warning:

- Carefully read and follow all warnings and instructions before installing or maintaining the luminaire.
- The installation and connection of the luminaire must be done when switched off and by qualified people.

## 8• Package

Product	Length	Outer Carton	Qty/Carton	Unit N.W	G.W/Carton
Trunking	1438mm	1630 x 375 x 210mm	8Pcs	1.5kg	16.0 Kg
Trunking	2876mm	3060 x 375 x 210mm	8Pcs	3.0kg	26.0Kg
LED Module	1438mm	1495x 375 x 120mm	6Pcs	2.1kg	13.5Kg

